

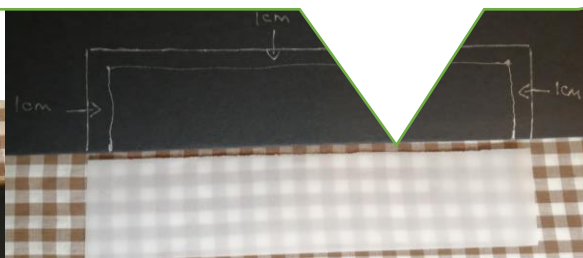

Create your own stained glass window.

1. Fold the tracing paper and black card lengthways and then place the folds together so that you find the centre



2. Glue tissue all over the tracing paper; you can be haphazard or create a pattern. Make sure that you cannot see the tracing paper!



4. Position the paper over the back of the window and glue or tape into place.

3. Cut out the window leaving a 1cm edge, so that the window is smaller than the tissue tracing paper.

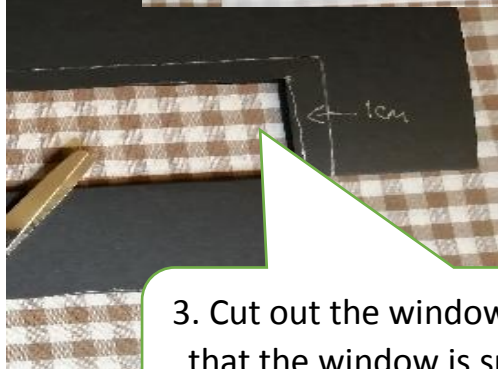

Add small details with a metallic pen!

Use the remaining black card to create 'lead' strips for your window.

